

With any medical test it is important that other factors do not interfere with your test result. Please read and follow these instructions carefully.

You must use the collection bottle provided by your doctor or SA Pathology. Bottles can be collected from any SA Pathology Patient Centre, locations are listed on the back of your SA Pathology Request Form.



Do not discard or touch any fluid or crystals in the bottle. Keep the lid on tight.

Collecting the specimen

Time is important - Remember to add 'AM' or 'PM' when recording the time e.g. 7:45AM

1. At bedtime

- pass urine into the toilet
- do not collect this specimen
- write the date, time, your name and date of birth on the label of the container

2. During the night

- each time you pass urine during the night collect it in a clean plastic container
- pour the urine into the collection bottle
- store the specimen in a cool place
- rinse the plastic container with tap water after each use.

3. When you get up in the morning

- pass urine into the plastic container
- pour it into the collection bottle
- write the date and time on the label.

Delivering the specimen

Deliver the specimen promptly to your nearest SA Pathology Patient Centre.

Your results

Your doctor will advise you when results are available.

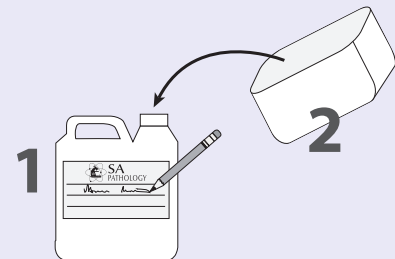

Patient Centres

For Patient Centre locations and latest opening hours visit our website www.sapathology.sa.gov.au or phone (08) 8222 3000.