

With any medical test it is important that other factors do not interfere with your test result. Please read and follow these instructions carefully.

You must use the collection bottle provided by your doctor or SA Pathology. Bottles can be collected from any SA Pathology Patient Centre, locations are listed on the back of your SA Pathology Request Form.



Do not discard or touch any fluid or crystals in the bottle. Keep the lid on tight.

Collecting the specimen

Drink your normal amount of fluids during the 24 hour period.

Day 1

- when you get up (eg 7:30am) pass urine into the toilet
- do not collect this specimen
- write the date, time, your name and date of birth on the bottle label

Collect ALL urine for 24 hours

- use a clean plastic container (rinse after each use)
- pour the urine into the collection bottle
- store the specimen in a cool place

Day 2

- at the same time as Day 1 (eg 7:30am)
- pass urine and collect it
- add it to the collection bottle
- write the date and time on the label

Delivering the specimen

Place the collection bottle into the ziploc plastic bag and then into the paper carry bag provided.

Deliver the specimen promptly to your nearest SA Pathology Patient Centre.

Your results

Your doctor will advise you when results are available.

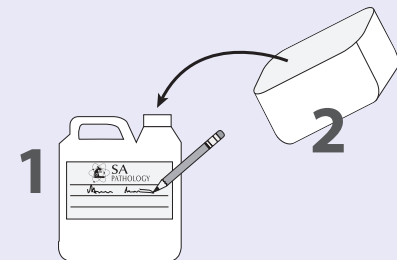

Patient Centres

For Patient Centre locations and latest opening hours visit our website www.sapathology.sa.gov.au or phone (08) 8222 3000.